



PLAN AMENDMENT APPLICATION

RECEIVED
JUL 12 2006
CITY OF MADERA
PLANNING DEPARTMENT

OFFICE USE
Project # _____
Date filed _____
Receipt # _____
Date accepted _____
Filing Fee: _____

APPLICANT INFORMATION (Please Print)

MADERA Commercial Avenue 17, LLC 310-475-8666
 Applicant Name Telephone Number
C/O WATT COMMERCIAL PROPERTIES 90405
 Applicant Address Zip Code
2716 OCEAN PARK BLVD # 3040 SANTA MONICA, CA
 Property Owners Name if other than the Applicant Telephone Number
 Property Owners Address if other than the Applicant Zip Code

PROPERTY INFORMATION

Assessor's Parcel Number (s) 033-040-007 + 033-050-017
 Site location or address NORTH SIDE OF AVE 17 WEST OF Highway 99
 Existing Zoning 033-040-007 NORTHERN-PRE-20 033-050-017-IL
SOUTHERN-IL
 General Plan designation 033-040-007 NORTHERN-rural RES 033-050-017- Light
SOUTHERN-light INDUSTRIAL FAMILIES
 Existing structures on the property NONE ON 033-050-017 / HOUSE, GARAGE, CONC PAD for DRIP
IRRIGATION MAINS ON 033-040-007

PROJECT INFORMATION

Proposed Land Use Designation (include Code references, and attach additional pages if necessary) C-2 both parcels

Proposed use or reason for the application (attach operational statement) Freeway oriented 100 acre retail development

DECLARATION

The undersigned hereby applies for approval of a Zoning Code Amendment as provided in Section 10-3.1501 of the Madera Municipal Code. I have completed this form accurately and declare that all statements hereon are true. I hereby grant official representatives of the City of Madera permission to enter onto and inspect the property proposed for development.

Applicant Signature _____ Date: _____
 Property Owner's Signature Richard J. Heller Date: 7-9-06
member

THIS APPLICATION MUST BE COMPLETED AND FILED WITH ALL MAPS, FEES, AND REQUIRED INFORMATION PRIOR TO ACCEPTANCE FOR PROCESSING.

PLANNING DIVISION
COMMUNITY DEVELOPMENT DEPARTMENT (559) 661-5430

PLAN AMENDMENT
DOC FOLDER / LRED
07/18/00 10:38 AM

Commercial Land Highway 99 & Avenue 17 Madera, California

Madera Promenade

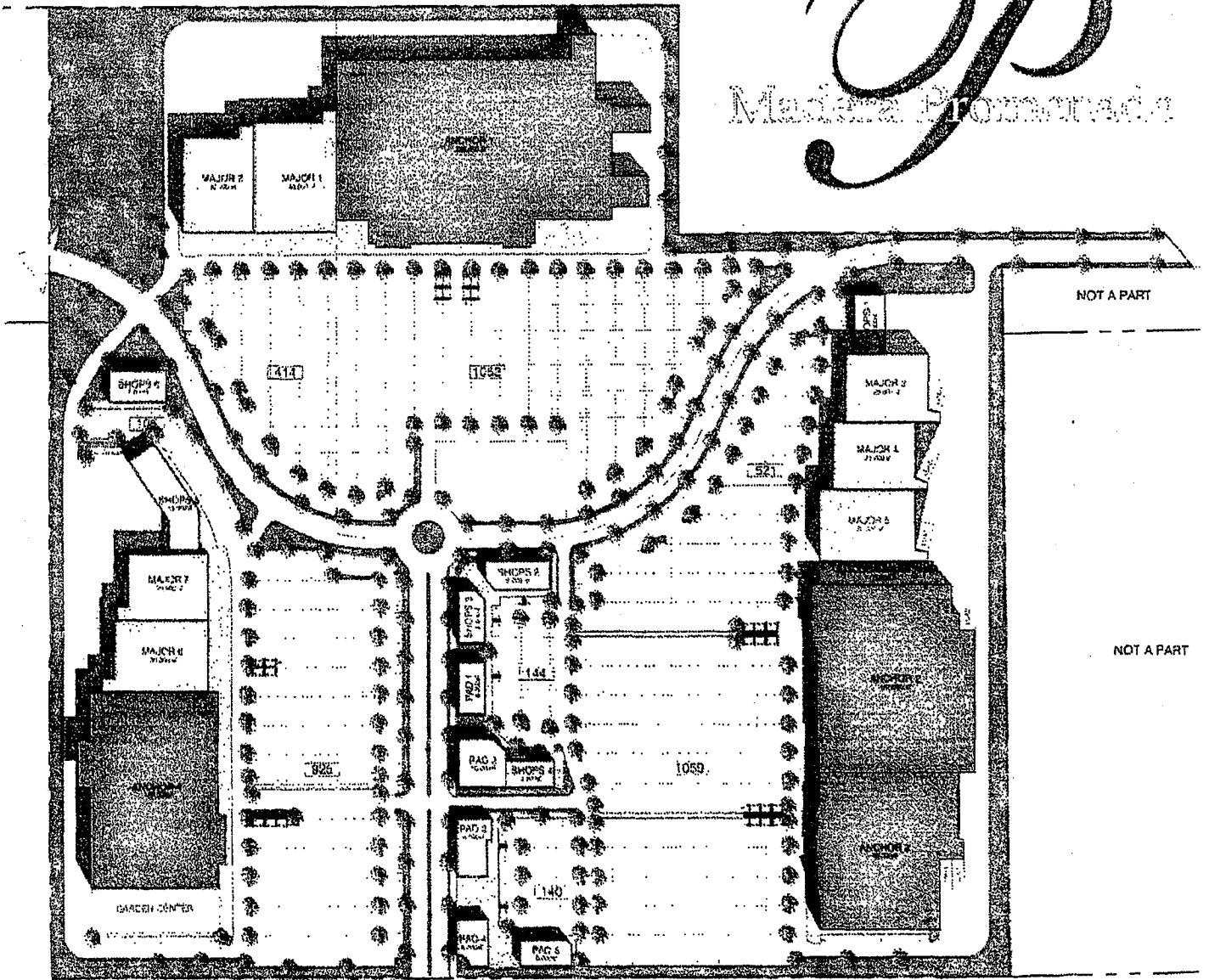

Site Plan